

PRESTRESSED CONCRETE TRIANGULAR PILE

Shape and Dimension

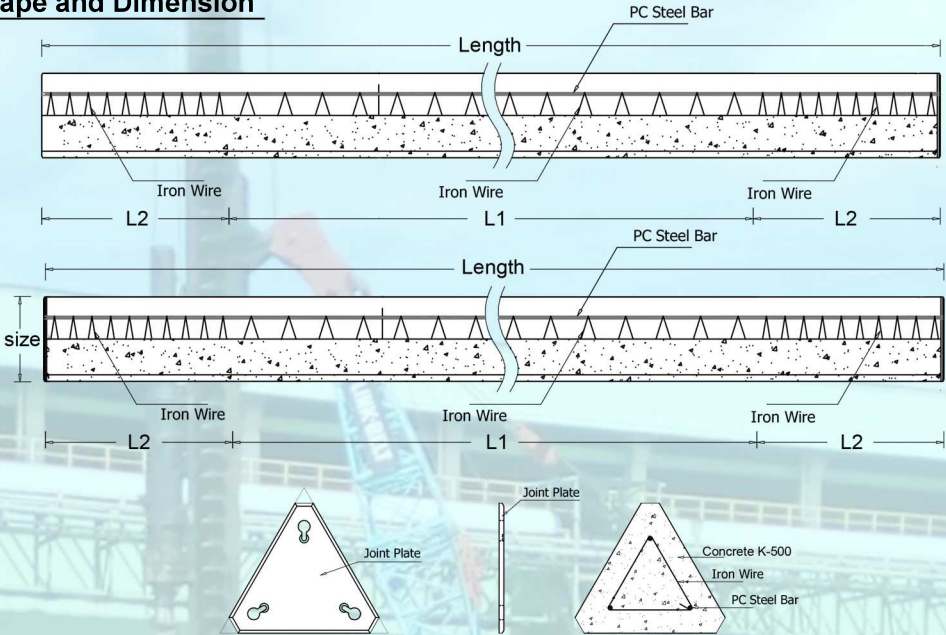

Description

Type of pile : Prestressed Triangular Pile
 System of Joint : Welded at steel plate
 Method of Driving : Drop Hammer, Hydraulic Hammer,

Design and Manufacturing References

| | | |
|--------|-------------------|--|
| Design | JIS A 5335 - 1987 | Prestressed Concrete Triangular Pile |
| | ACI 543R - 00 | Design, Manufactured and Installation of Concrete Pile |
| | SNI 03-2847-2002 | Indonesian Concrete Code |

Dimension of Triangular Pile

| Size (mm) | Bending Moment | | Allowable compression (ton) | Length (mm) |
|-----------|----------------|------------------|-----------------------------|-------------|
| | Crack (ton.m) | Ultimate (ton.m) | | |
| 225 x 225 | 0,50 | 0,75 | 24,00 | 3000 - 6000 |
| 280 x 280 | 0,66 | 0,92 | 38,00 | 3000 - 6000 |
| 320 x 320 | 0,99 | 1,44 | 46,00 | 3000 - 6000 |

HEAD OFFICE

Jalan Padang By Pass Nagari Kasang,
 Kec. Batang Anai, Padang Pariaman,
 Sumatera Barat-25586

Telp : 0751-480032 / 483417 / 483527
 Fax : 0751-480033

MARKETING OFFICE

Jalan Perintis Kemerdekaan Komp. Grand Jati Junction
 Blok T No.9 , Medan,
 Sumatera Utara-20218

Telp : 061-80513565 / 80513327
 Fax : 061-80514538