

PRESTRESSED CONCRETE SHEET PILE FLAT TYPE

Shape and Dimension

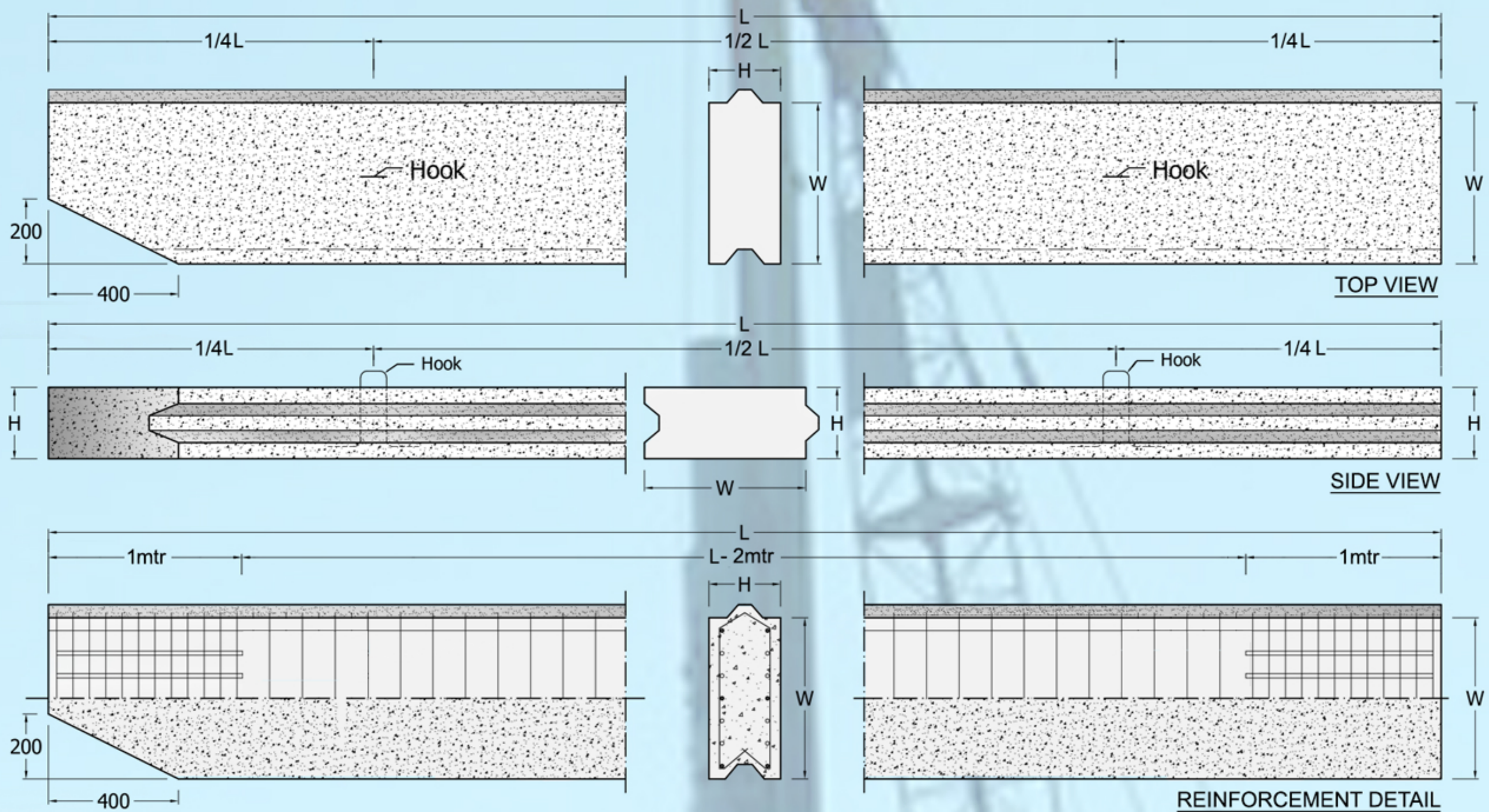

Type of Sheet Pile

- PC FSP (Prestressed Concrete Flat Sheet Pile)

System of Joint Between Pile

- Male - female (Standard)

Method of Driving

- Vibro or Diesel Hammer (Standard)

Design and Manufacturing Reference

JIS A 5326 - 1988	Prestressed Concrete Sheet Pile
SNI 03-2847-2002	Indonesian Concrete Code
JIS A 5373 - 2010	Precast Prestressed Concrete Product

Spesification

Type	Class	Width W (mm)	High H (mm)	Cross Section (cm ²)	Unit Weight (kg/m)	Cracking Bending Moment (ton.m)	Length (m)
FSP - 220 A 500	A	500	220	1,095	275	3.32	6 - 10
	B					3.70	6 - 10
	C					4.05	6 - 10
	D					4.39	6 - 11
	E					4.71	6 - 11
	F					5.22	6 - 11
	G					5.97	6 - 12
FSP - 320 A 500	A	500	320	1,595	400	6.05	6 - 11
	B					6.65	6 - 11
	C					7.24	6 - 11
	D					7.81	6 - 12
	E					8.37	6 - 12
	F					8.91	6 - 12
	G					9.43	6 - 13
	H					9.94	6 - 13
	I					10.43	6 - 13
	J					10.91	6 - 14
	K					11.37	6 - 14
	L					11.81	6 - 14
	M					12.24	6 - 15
	N					13.88	6 - 15